



Verplas Thermal Ducting Range

Installation Guide - 204x60mm, 220x90mm Rectangular, 125mm & 160mm Round

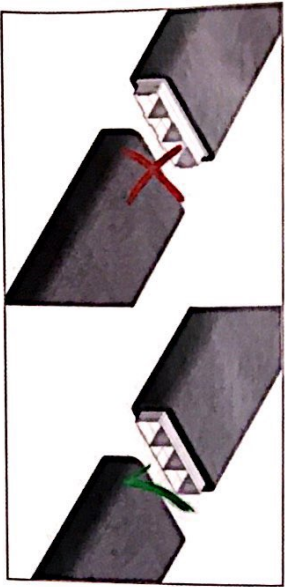
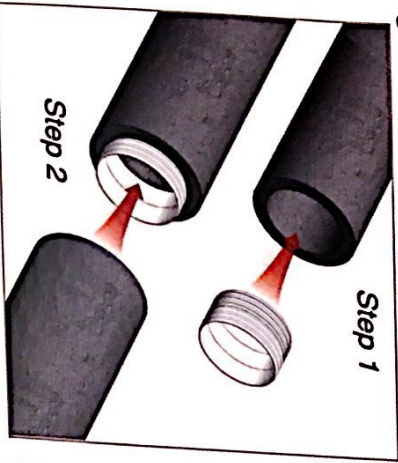

Figure 3: Connecting Long Duct Runs

Verplas thermal ducts are supplied complete with a bonded Duct to Duct connector as indicated and ticked in figure 3 above. Gently but firmly insert the open end of the next length of duct onto the Duct to Duct connector until the EPS foam meets

Figure 4: Connecting Duct Off-Cuts



Insert the Verplas Duct to Duct connector into the section of ducting and push firmly using the depth guideline provided. Once inserted, place the second section of ducting over the connector and gently push firmly together to create a low leakage seal.

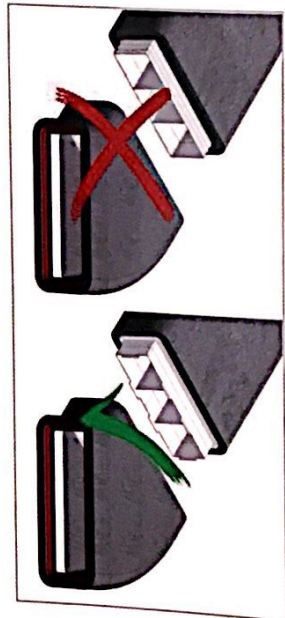
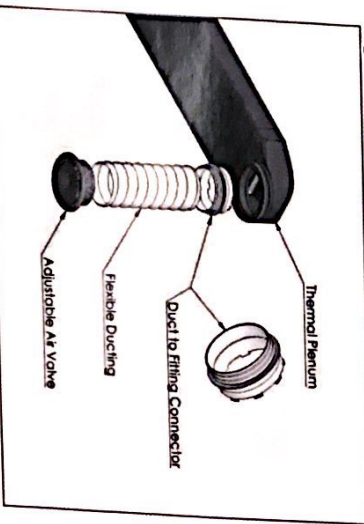

Figure 5: Connecting Ducts to Fittings

When joining a section of thermal ducting to a fitting such as a bend, insert the Duct to Fitting connector into the open end of the duct down to the flange on the connector and with the castellations on the outside, then gently push the ducting into the chosen fitting. The click and lock sound will indicate when the 2 pieces are firmly in place to form a seal.

Figure 6: Plenum to Flex Connection



To connect Verplas thermal to flexible 125mm diameter flexible ducting, please insert the Duct to Fitting connector into the plenum, attach the 125mm flexible to the Duct to Fitting connector and secure using an appropriate method such as a cable tie.

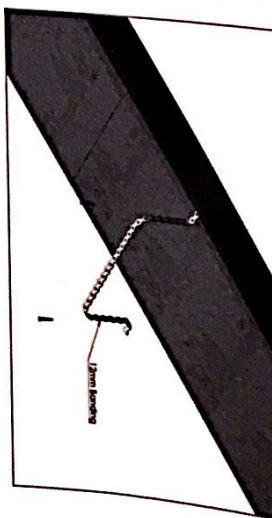
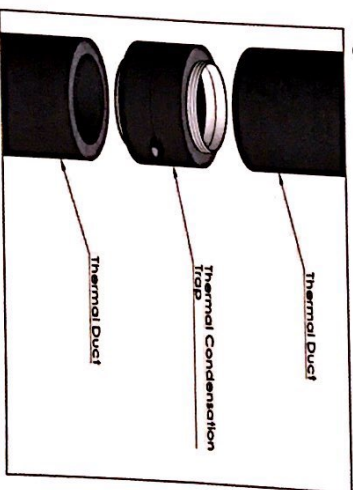

Figure 7: Securing Thermal Ducting

Verplas Thermal ducting should be secured in place using PVC Coated Banding fixed to an appropriate surface. The ducting should be secured at a maximum of 750mm intervals in line with current Building Regulations and the Domestic Ventilation Compliance Guide 2010.

Figure 8: Condensation Trap



To connect the condensation trap, fully insert both Duct to Duct connectors into the thermal ducting either side and gently push together to form a tight seal. Install vertically and run a pipe from the drain connection to an appropriate drainage location such as a soil and vent pipe.



Verplás Thermal Ducting Range

Installation Guide - 204x60mm, 220x90mm Rectangular, 125mm & 160mm Round



LFT 119 (Rev.0)

Verplás Thermal Ducting Range:

Verplás Thermal Ducting Range is designed for use with domestic ventilation systems installed in residential applications.

Verplás Thermal is available in 4 system sizes, Rectangular 204x60mm and 220x90mm and Round 125mm and 160mm (all dimensions are internal duct sizes).

The Verplás Self-Seal Thermal is manufactured from Neopor® graphite impregnated expanded polystyrene (EPS) with infrared absorbers and reflectors which significantly reduce the thermal conductivity of the material, thereby increasing the thermal resistance.

Verplás Thermal is a complete ducting system which requires no PVC Duct lining. The EPS body forms a strong, smooth and robust all in one solution.

All System Sizes utilise the patent pending push, click and lock mechanism to ensure joint integrity and ease of installation, with female couplings housed in the Fittings and male Duct to Fitting connectors pushed into the Duct. There are no additional requirements for tape, screws or sealant.

Designing Your Ducting System:

The most important part of any ventilation system is the design of the ducting installation. Verplás recommend that any ventilation system is designed by a qualified person to ensure that the quietest, most energy efficient and cost effective solution is selected. For further information contact your chosen ventilation system provider.

Installing Your Ducting System:

Verplás recommend that all residential ventilation systems and ducting are installed and commissioned by an accredited BPEC installer. Further details should be available from your chosen fan supplier.

The installation must be in compliance with the appropriate governing body regulations and approved methods.

For guidance see www.verplás.co.uk/downloads under document - domestic ventilation compliance guide for installers.

Figure 1: Cutting Verplás Thermal

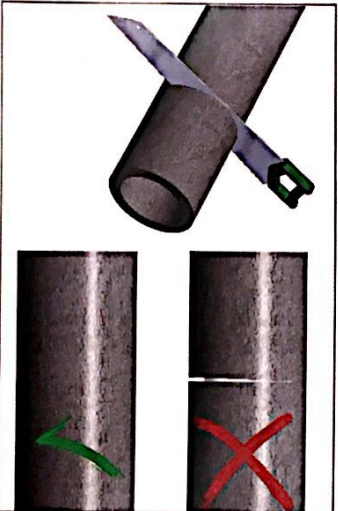

When cutting Verplás Thermal Ducting we recommend the use of a fine tooth saw or similar to ensure a clean cut. Use a straight edge to provide a cutting guide.

Neopor® is a registered trademark of BASF SE

Figure 2: Thermal Connectors

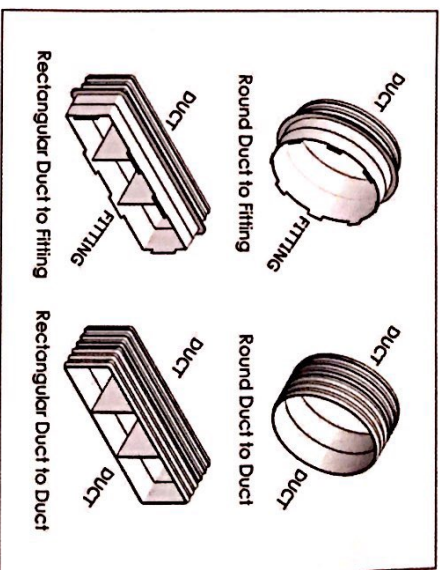

Verplás Thermal ducting is supplied complete with all the necessary connectors as shown in figure 2.

The Duct to Fitting connectors are supplied loose with all the fittings such as bends and T-pieces. The fitting side is designed to push-fit into the female couplings housed in the fittings and the ribbed side is designed to push-fit into the open end of a length of duct. Please ensure that these are inserted the correct way round. (see figures 5 & 6)

The Duct to Duct connectors are supplied pre-inserted in the duct, 1 per section of either 1m or 2m lengths (see figure 3).

The Duct to Duct connectors supplied with the duct are bonded in position within the thermal ducting for speed of installation on longer duct runs. Simply insert the Duct to Duct connector into the next open end of the duct and gently push firmly together to form a low leakage seal.